



DIGITAL (LED) PLATES



- **Model (with Display Screen, Size & Weight):** (a) P3 2480 Wafer Thin Size 15in W x 7.5in H Weight 440gms (b) P2 2481 Bag Plate Size 7.75in W x 10.45in H Weight 460gms (c) P3 2482 Food Bag Size 11.33in W x 7.75in H Weight 340gms
- Processor-embedded
- **Power Consumption:** (a) P3 2480 Wafer Thin 10K mAh Powerbank lasts 5 Hours (b) P2 2481 Bag Plate 10K mAh Powerbank lasts 8 Hours (c) P3 2482 Food Bag 10K mAh Powerbank lasts 5 Hours
- **Power Supply:** DC5V 2A by USB Power Bank or direct power supply via Mobile Dock / Adaptor
- **Nits / General Life Duration:** (a) P3 2480 Wafer Thin 2000-2500 Nits with SMD Lamps 3535 (b) P2 2481 Bag Plate 800-1000 Nits with SMD Lamps 3535 (c) P3 2482 Food Bag 3000-4000 Nits with SMD Lamps 3535 / 1921
- Supports Image / Text / GIFs without Audio
- Control via Bluetooth & Mobile Application
- 1 Year Warranty for LED Panel*

**Terms Apply*

Got questions about our Digital Plate? Check out the FAQs

- 1. Can we customize the content on Plate and add audio or play live?** Yes, it is D.I.Y programmable content. Using Mobile App, you can put Image / Text / GIFs without Audio. It does not allow live streaming or direct internet video broadcast. The memory of this Plate is limited to support upto 40MB Brand Logos, static Social Media Posts or limited Animations like Monogram, etc. The Plate does not support sound ie. there's no audio output. Also to note, in case of more white-coloured visuals, the power consumption and heating will be a little higher compared to other colour visuals
- 2. Can we update video of up to 1min also on this Plate?** Yes, just that you would need to convert to .GIF in case file is too large
- 3. Does the content support Unicode?** It does not support Unicode content, so instead create an image in JPG/PNG and put them up
- 4. Is this screen viewable from extreme closeness?** The ideal viewing distance is 6ft onwards and would look legitimate upto 50ft. In case it still looks blur check with the creative size dimension and ensure its as per the specified size & format
- 5. Is it weather or water proof? Does it get heated up easily?** No, it is not waterproof but we can offer a plastic cover to help it be used for Outdoors. For heating issue, the product gets little heated on continuous usage (just like our laptops) but is within defined standards
- 6. How do we update the content from mobile?** Once you buy the Plate, we offer the Mobile App access which runs on both Android & iOS phones. We also offer a Demo Video & Manual on how to use that App
- 7. Can we update multiple Plates using 1 Mobile App?** Yes, you can have 1 app manage content across multiple devices. Geographically you need to be in the proximity of 15ft of device without obstruction. You can add / edit / remove content from single phone but the only catch is it will 1 device content at a time and not simultaneously. Though our application is cloud-based with a robust content management system (CMS) we do not offer centralized access and control of displays across multiple locations ie. you need to place our products in proximity for multi-device management
- 8. What are the variations of your Plates? and its cost?** We have three models: **2480Wafer Thin** is 15in W x 7.5in H in Size, **2481Bag Plate** is 7.75in W x 10.45in H in Size & **2482Food Bag** is 11.33in W x 7.75in H in Size. For our standard SALES price, click [here](#). We DO NOT provide Power Bank along due to regulatory issues in sending via parcel but it does include USB Extender Cable and 1 Year warranty for LED Plate (but not on the add-ons objects bought along as Combo via Unique Code). In case someone wishes for extended warranty by additional 2 years, it can be done at an extra cost. We do not have any Minimum Order Quantity (MOQ) for now. We also offer our Plates with other objects in 25+ different Combos for SALES or RENTALS. For Rental rates, click [here](#).
Note: We are only into SALES / RENTALS of Plates and not undertaking Media Sales project
- 9. Does it need any additional Hardware Accessories?** Yes, it requires a Power Bank which needs to be managed by buyer's side. We DO NOT provide Power Bank along due to regulatory issues in sending via parcel. For direct power supply to Plates, we do provide a USB Extender Cable of 1.5m/3m along
- 10. Why can't you put a Tab/TV screen instead of LED?** TV or Tab screens of this size will be highly expensive, heavy in-weight and have higher chances of breakage. The brightness in daylight and reflection are additional issues
- 11. Does it require any specific local body Permission/Compliance before display?** In case its placed for your own marketing whether Indoors (includes within private premises of Building Lobby, Mall, Events, etc.) it does not require any permission. But if you plan to place it Outdoors and run multiple brand ads across it, kindly check for the local Government norms
- 12. Can you customize Plates into my existing office setup or any unique requirement?** Yes, we can take on such customization. Do reach out to us and we can take this forward.

LOY PLAY user manual

1. Scan the QR code to download APP with your phone



2. After install the APP, when start it, please turn on Bluetooth and GPS in your phone



3. log in with your account
need register account for first-time user

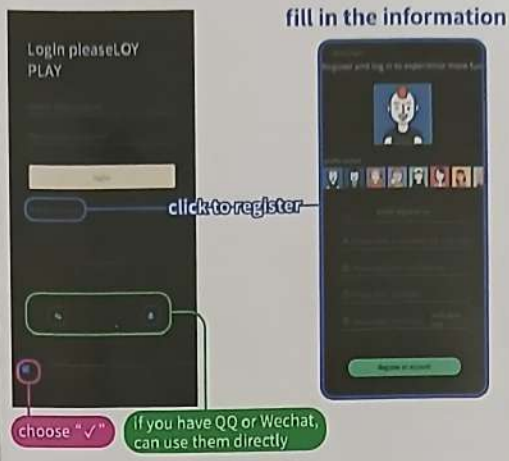

4. connect with device ID

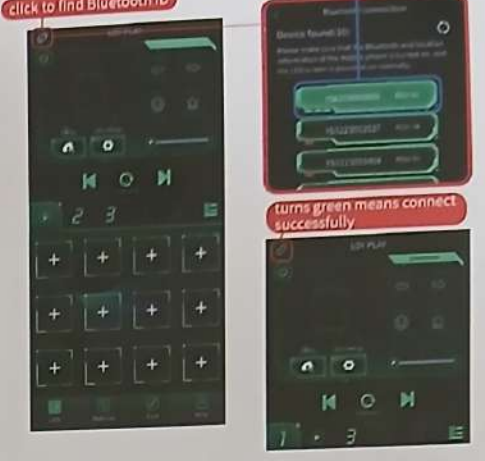

5. create new program and send to screen



(1) add image/animation
choose image/animation in your phone



(2) colorful text
edit any text you like, send to screen

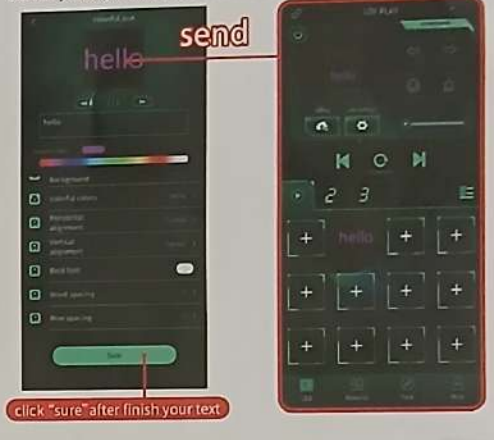

(3) material library
choose image/animation from material library

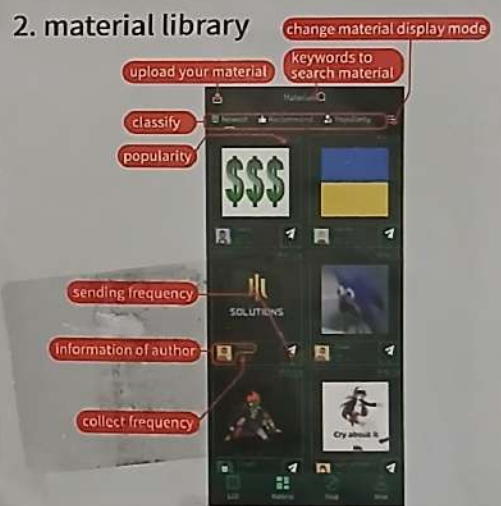
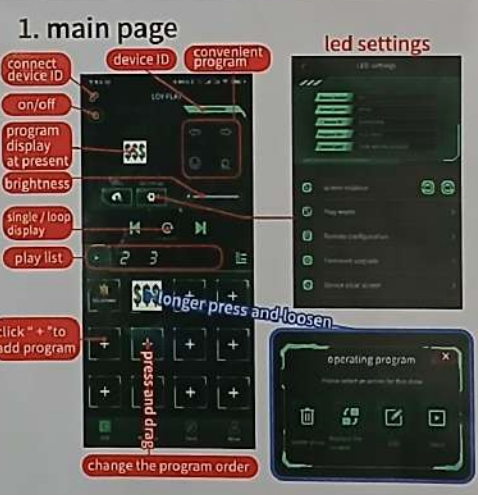

3. Find



4. Mine

